

0.156(3.96) Test Centers 1353L Series

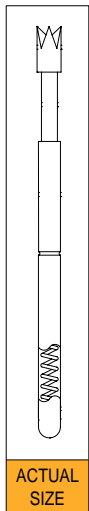
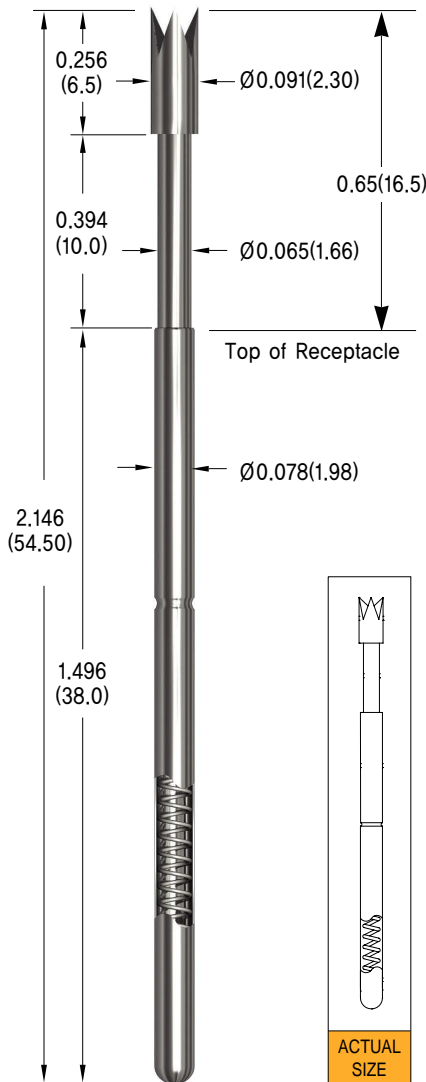
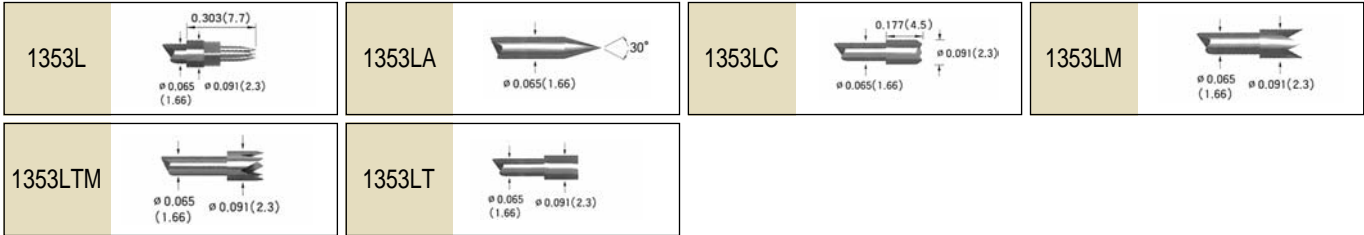

Probe Specifications

Electrical(Static Conditions)

Current Rating : 8 amps continuous
 Probe Resistance : Less than 30 mΩ

Materials and Finishes

- Plunger - Full-hard beryllium copper, palladium plated over nickel (optional gold plated over nickel)
- Barrel - Brass, Nickel plated
- Spring - Music Wire
- Ball - Stainless steel, gold plated

Spring Force	± 20%	oz(grams)
Preload	Recommended Travel	Full Travel
	0.264(6.7mm)	0.394(10.0mm)
4.413(125)	12.002(340)	15.603(442)

Receptacle Specifications

- Housing : Brass, nickel plated
- Round Post : Brass, nickel plated
- Square Post : Brass, gold plated
- Mounting Hole Size : 0.094(2.40mm) drill is most commonly used

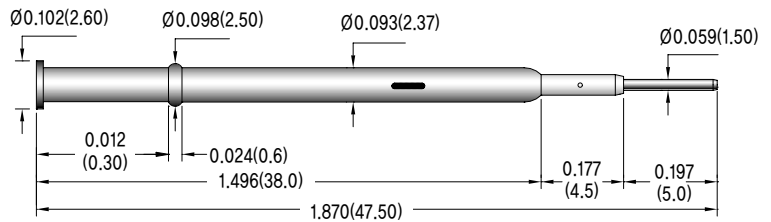

1353LTW Wire-Wrap Receptacle



1353LW

Wire-Wrap Receptacle

